



Wayfinding Guide  
Gainesville



Whether you are here for a doctor’s appointment, medical testing or to visit a patient in the hospital, we are committed to making your experience as comfortable and convenient as possible.

Dining

Enjoy delicious meals, snacks, coffee and assorted beverages at the cafeteria.

Gift Shop

The Window Shop is located on the first floor and offers a variety of gift options including cards, jewelry, and more.

Wi-Fi information

Free wireless internet service is accessible from personal devices in patient rooms and waiting areas. The network is NGHS-Guest, and after completing a short form, you may connect using a username and password.

Visiting Hours

Family members and other partners in care are welcome to visit patients. Please visit [nghs.com/visitation](https://nghs.com/visitation) or ask a representative at the registration desk for the most up-to-date visitation guidelines. For security purposes, we will close all entrances except the emergency room entrance from 9 p.m. until 6 a.m. Please enter and exit our facility through the ER during those hours.

Services

- Emergency Services
- Orthopedics
- Pulmonary Rehabilitation
- Heart services
- Imaging / Radiology
- Laboratory Services
- Wound Healing
- Surgery



Departments & Areas

Department	Location	Page	Department	Location	Page
Administration	1st Floor	5	Mother/Baby	2nd Floor	6
Auxiliary Conference Room	Ground	4	<i>Enter through Women &amp; Children's Pavilion Entrance</i>		
Cardiac Catheterization Lab	4th Floor	8	Neonatal Intensive Care Unit (NICU)	Ground	4
Cardiac Observation Unit	1st Floor	5	Neurosciences	1st Floor	5
Cardiology & Vascular Lab	3rd Floor	7	Northeast Georgia Physicians Group (NGPG) Cardiovascular & Thoracic Surgery	Wisteria	11
Cashier	1st Floor	5	Northeast Georgia Physicians Group (NGPG) Vascular Surgery	Wisteria	11
Dialysis	1st Floor	5	Observation Units	1st Floor	5
Emergency	1st Floor	5	Pediatrics	3rd Floor	7
Emergency Observation Unit	Ground	4	Pre-Surgical Testing/Clinic	1st Floor	5
Employee Health	Ground	4	Puckett Center for Spiritual Care	1st Floor	5
Endoscopy	1st Floor	5	Radiation Therapy	Ground	4
ER Area G, H	1st Floor	5	Rehabilitation	4th Floor	8
Financial Assistance	1st Floor	5	Respiratory Therapy	Ground	4
Fraser Resource Center (Library)	1st Floor	5	Ronnie Green Heart Center CVICU	2nd Floor	6
GME Suite 1400	1st Floor	5	<i>Enter from 1st floor North Patient Tower elevator F</i>		
Hall of Honor	1st Floor	5	Ronnie Green Heart Center CVICU	3rd Floor	7
Hospice Patient Rooms	5th Floor	9	<i>Enter from 1st floor North Patient Tower elevator F</i>		
Georgia Heart Institute	Wisteria	11	Sam Jones Cath Lab Observation Unit	1st Floor	5
Human Resources	Ground	4	Security	1st Floor	5
Imaging	1st Floor	5	Suites 710-750	Ground	4
Infusion/Chemotherapy	1st Floor	5	Surgery	2nd Floor	6
Intensive Care Unit	3rd Floor	7	Volunteer Services	1st Floor	5
Labor & Delivery	1st Floor	5	Walters Auditorium	Ground	4
Laboratory	2nd Floor	6	Walters Auditorium Entrance	1st Floor	5
Lab	1st Floor	5	W. D. Stribling Heart Clinic	3rd Floor	7
Laurelwood Intake	1st Floor	5	Woody Stewart Heart Failure Treatment Unit	2nd Floor	6
McKibbon Chapel	1st Floor	5			
Medical Observation Unit	1st Floor	5			

Legend

- Restrooms
- Stairs
- Elevator
- Registration
- Information
- Dining
- Vending
- Gift Shop
- ATM

# G Floor

- Restrooms
- Stairs
- Elevator
- Registration
- Information
- Dining
- Vending
- Gift Shop
- ATM





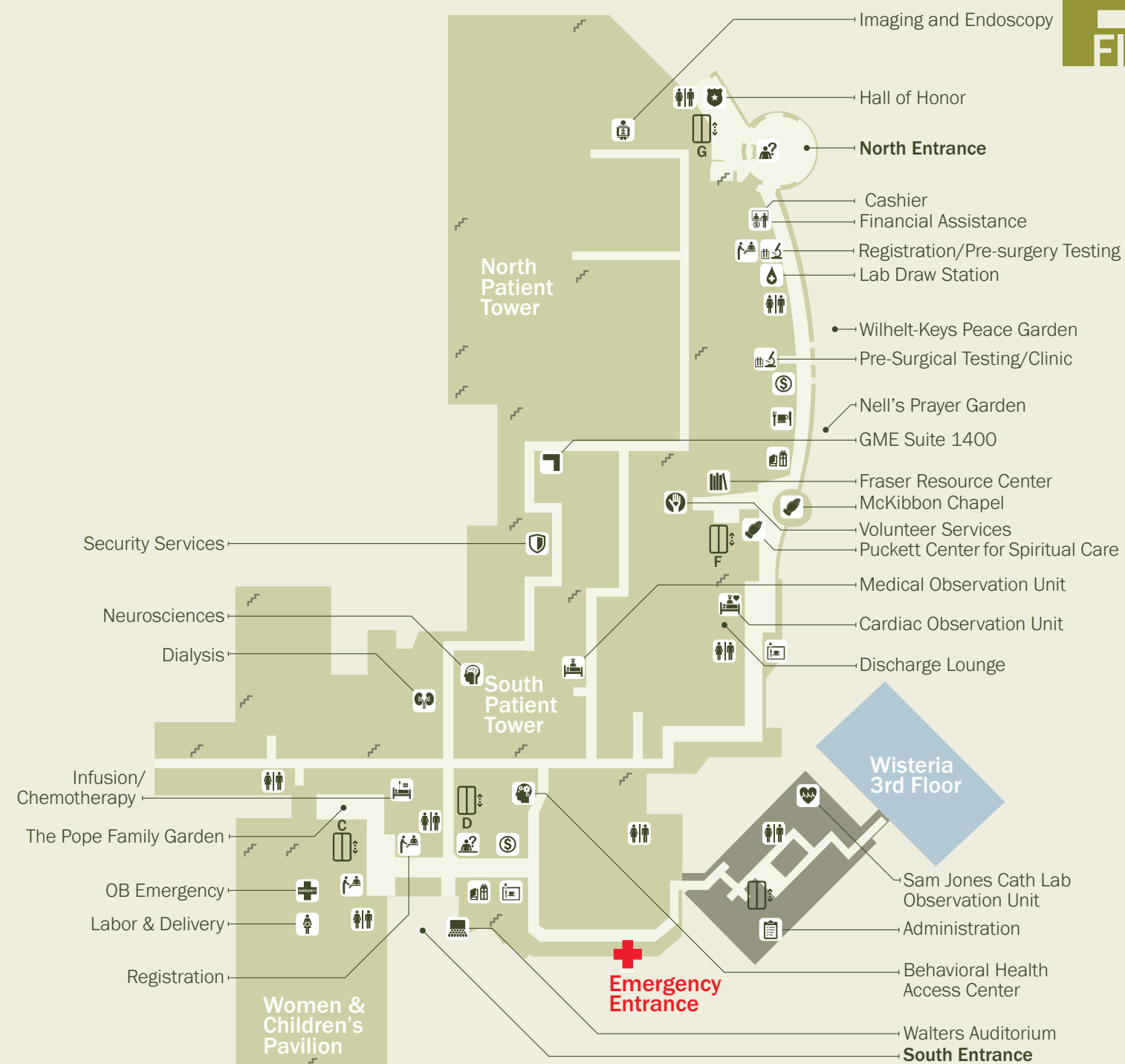

# 1st Floor

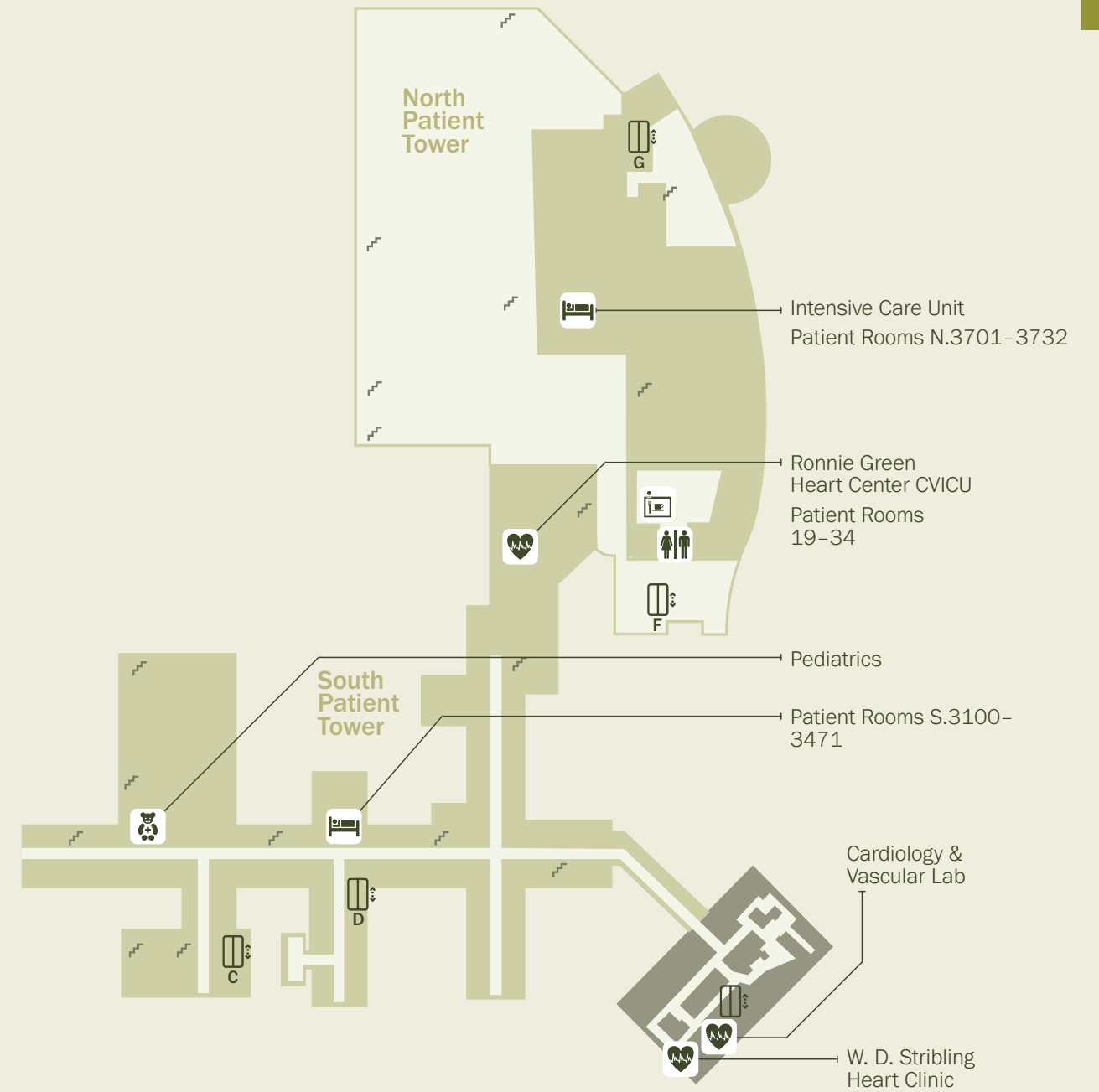

- Restrooms
- Stairs
- Elevator
- Vending



-  Restrooms
-  Stairs
-  Elevator
-  Vending

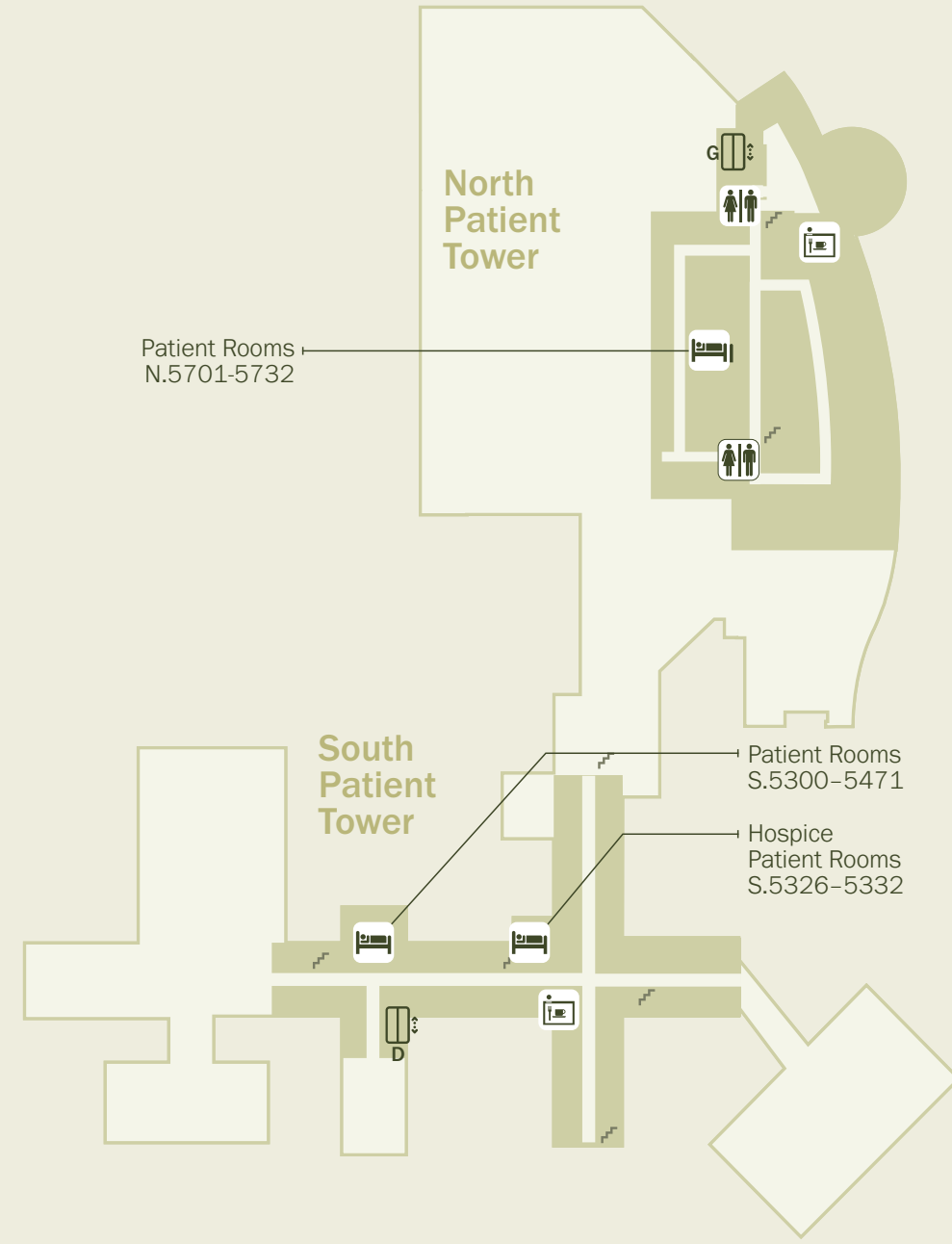
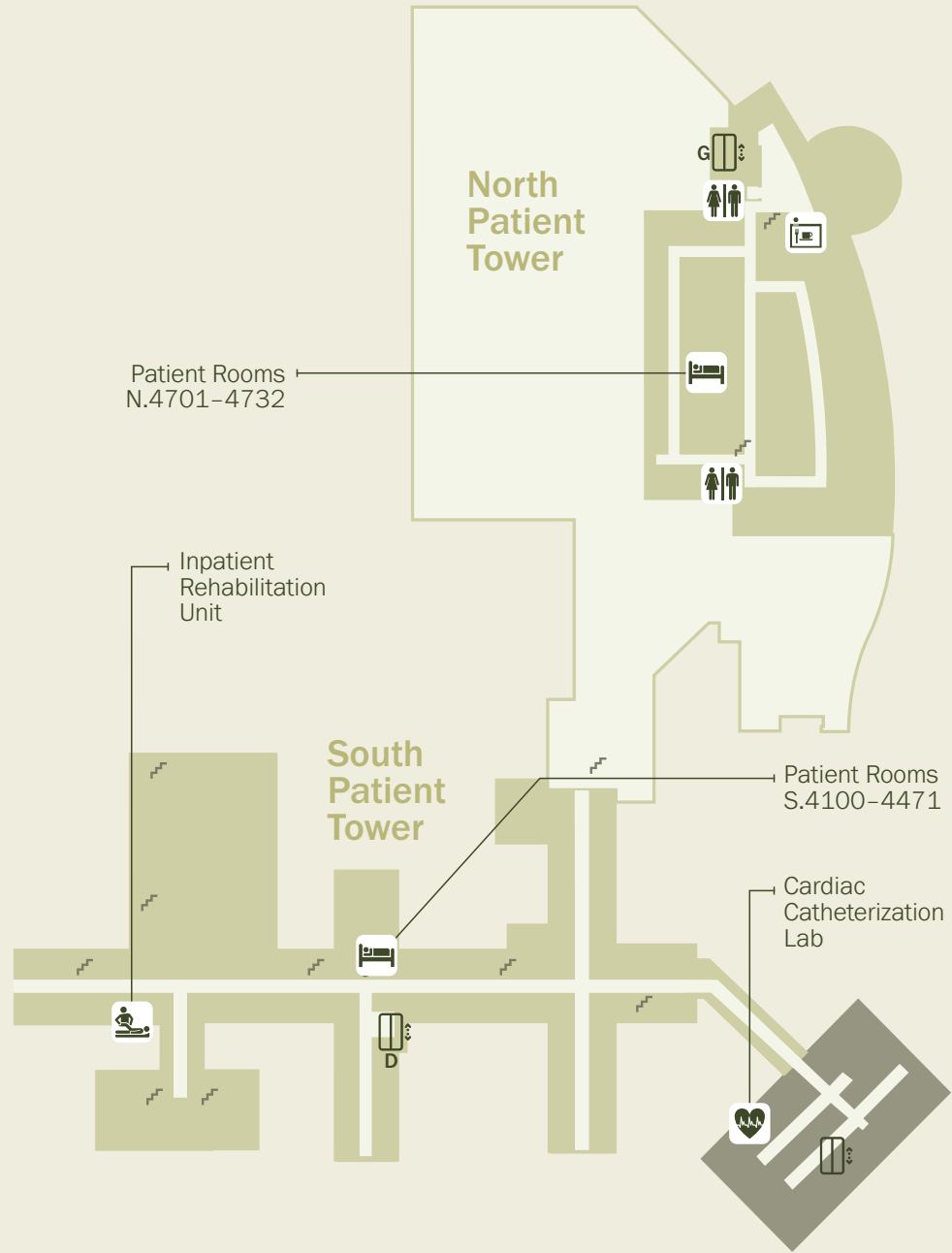

- Restrooms
- Stairs
- Elevator
- Vending

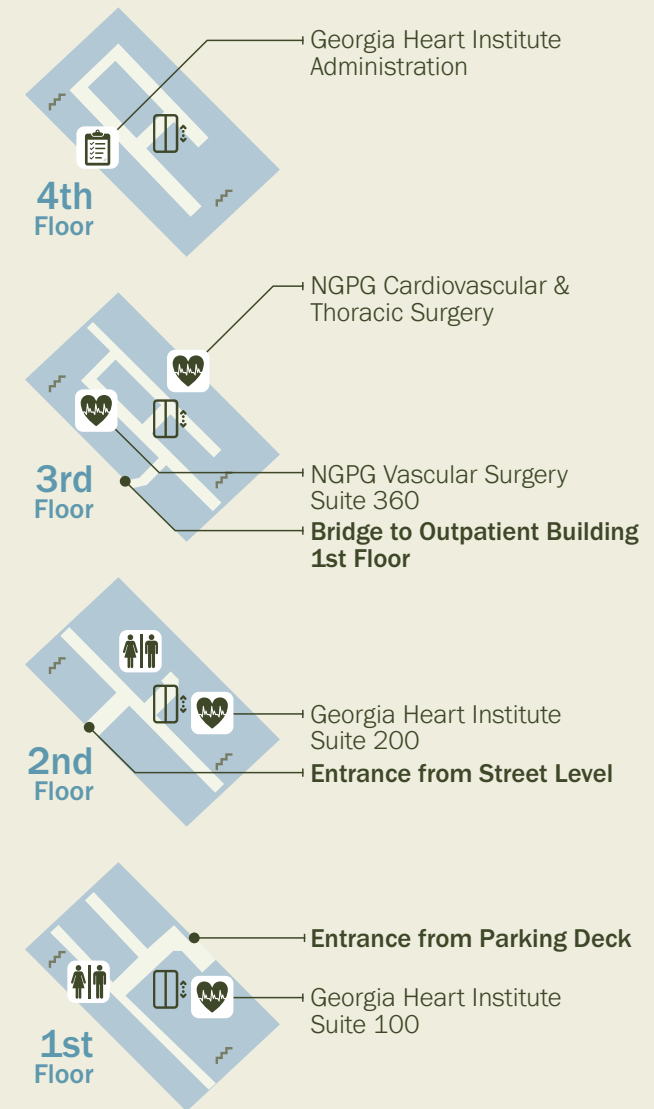
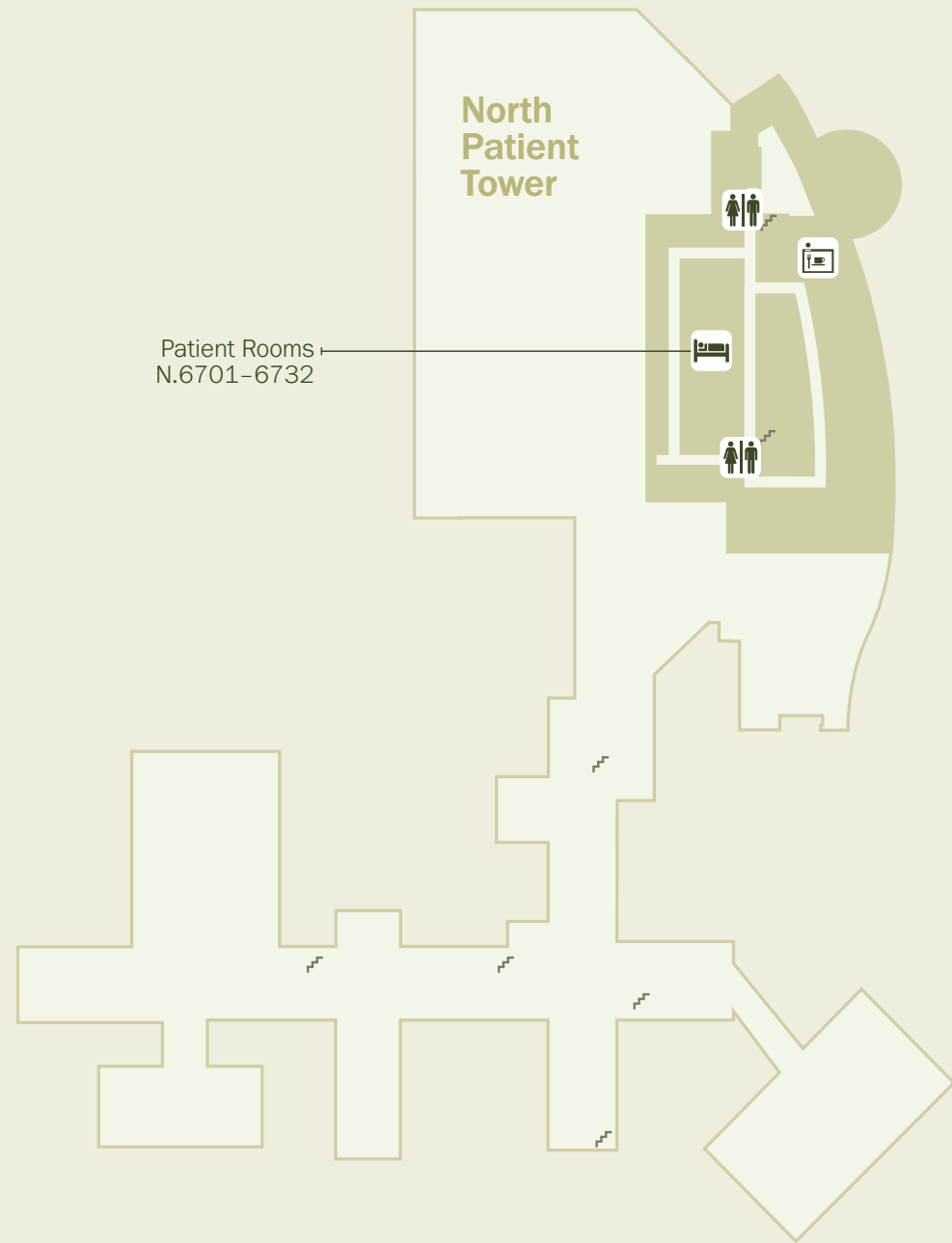



Your Destination

Department Name

Room#

Physician Name:

Zone

Level

Contact Phone Number:

Directions

From the South on I-985 Northbound

- Take exit 22 for US-129 toward Gainesville/Jefferson
- Use the left 2 lanes to turn left onto E E Butler Pkwy (signs for US 129 N)
- Continue on E E Butler Pkwy/US 129 N for 1.5 miles
- Turn right onto Jesse Jewell Pkwy SE
- Continue on Jewell Pkwy SE for .6 miles
- Turn left onto Wisteria Drive

From the North on US-23 Southbound

- Take exit 24 for U.S. 129 N/GA-369 W toward Gainesville/Cumming
- Use the right 2 lanes to turn right onto GA-369 W/ US-129 N/Jesse Jewell Pkwy SE
- Continue to follow GA-369 W/Jesse Jewell Pkwy SE for 1.8 miles
- Turn right onto Wisteria Drive



Northeast Georgia Medical Center  
GAINESVILLE

743 Spring Street | Gainesville, GA 30501 | 770-219-9000 | [nghs.com](http://nghs.com)